

LINA™ Compact Linear Line Array Loudspeaker



LINA excels in array performance, providing exceptional high frequency headroom, phase coherence and consistent coverage in a light, compact cabinet making it extremely versatile.

A newly-designed class D amplifier affords unprecedented efficiency to LINA. This innovative new amplifier, signal processing and drivers ensure that LINA systems reproduce any sound source with linearity over a wide dynamic range, from speech and classical music to rock and EDM.

Its low weight and small size make it ideal for use in low-profile, high-power curvilinear array systems and an excellent choice for small theatres, theme parks, houses of worship, AV systems, and any venue where size and weight are concerns and exceptional fidelity and intelligibility are requirements. LINA is also well-equipped for use as a single cabinet or for use with a small number of cabinets for applications requiring a precise, high-frequency vertical pattern. Single cabinets and short stacks are ideal for front fill and under-balcony applications. In addition to working as a standalone system, LINA can also be used as a supplemental fill loudspeaker in LEOPARD systems.

The LINA compact linear line array loudspeaker is the logical evolution of the highly successful MINA loudspeaker now optimized using the latest technology that makes the LEO™ family an award-winning product line.

LINA delivers the same signature and advantages of self-powered design, linear response, and precise directional control as its bigger siblings LEO-M™, LYON™ and LEOPARD™. LINA loudspeakers, like its sibling

LEOPARD, use Native Mode optimized for use with minimal external processing, yielding excellent system performance right out of the box.

Taking advantage of the same compact external dimensions and rigging as MINA, the new LINA faithfully reproduces audio with tremendous power, superior intelligibility, and extremely low distortion.

For low-frequency extension, LINA pairs with Meyer Sound's 750-LFC low-frequency control element, which can be flown as part of LINA arrays without any transition hardware. The 750-LFC shares with LINA the advantages of excellent power-to-size ratio, efficiency, and versatility.

For applications requiring more low-frequency headroom, Meyer Sound's 900-LFC is also suited for integration with LINA systems.

LINA includes Meyer Sound's QuickFly® rigging with captive GuideALinks™, which are compatible with MINA and allows easy setting of splay angles from 1 to 11 degrees. Rigging options are shared with MINA and include the MG-MINA/750-LFC multipurpose grid, MCF-MINA caster frame, MYA-MINA Yoke and MUB-MINA U-bracket.

Entire LEO family systems should be designed with Meyer Sound's MAPP-XT, effectively anticipating system SPL and coverage needs.

The use of the MDM-832 distribution module routing AC power, balanced audio, and RMS™ to multiple LINA loudspeakers further enhances the portability and easiness to configure a system.

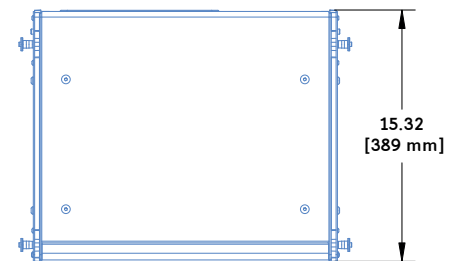
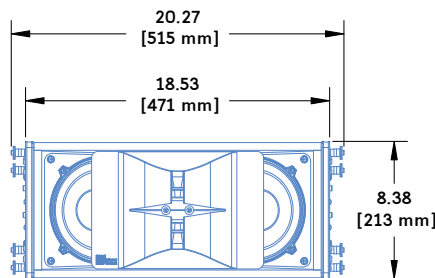
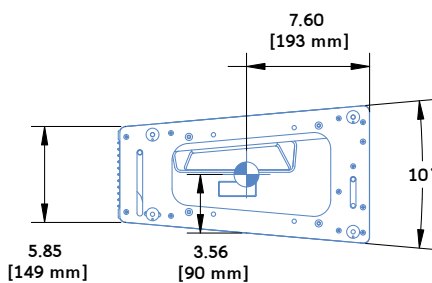

FEATURES & BENEFITS

- Small footprint and narrow width ideal for small venues and fill applications
- Amazing power-to-size ratio
- High peak power output with exceptional linearity and transient reproduction, at any operating level, with extremely low distortion

- Self-powered for simplified setup and increased reliability
- Flexible rigging for flown and ground-stacked arrays
- Integrates easily with Meyer Sound's 750-LFC, 900-LFC and LEOPARD loudspeakers

SOLUTIONS

- Small theatres and touring productions
- Houses of worship, ballrooms, and corporate AV
- Theme parks
- Front fill and under-balcony coverage
- Side fill for LEOPARD systems

LINA ACCESSORIES

MG-MINA MULTIPURPOSE GRID

Flies up to 16 LINA or MINA cabinets at a 5:1 safety factor and BGV C 1. The grid offers multiple and single-center pickup points and can also be used for ground stacking. It can also be used to fly or groundstack 750-LFC.

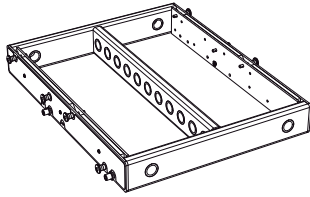

MYA-MINA YOKE

Suspends arrays of up to three LINA or MINA cabinets from a single point. In addition it pole-mounts up to two cabinets on top of a 750-LFC. (pole-mount adapter not included).

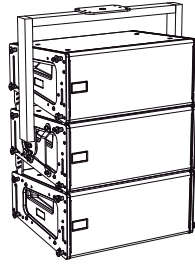

GALILEO GALAXY ARRAY PROCESSOR

The Galileo GALAXY provides state-of-the-art technology in audio control in driving and aligning loudspeaker systems with multiple zones. With immaculate sonic performance, it provides a powerful toolset for corrective room equalization and creative fine-tuning for a full range of applications. In addition GALAXY allows integrating LINA with different Meyer Sound loudspeakers with its improved Delay Integration.

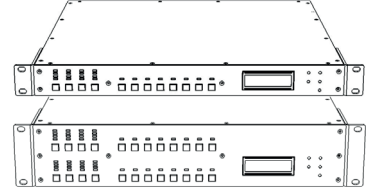

MCF-MINA CASTER FRAME

Transports up to five fully-rigged LINA or MINA cabinets. Durable nylon covers, sized for stacks of 3, 4, and 5 units, are also available to ensure the LINA is completely road ready.

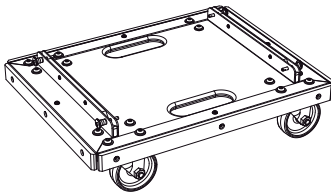

MUB-MINA U-BRACKET

Mounts up to three LINA or MINA cabinets for front fill or under-balcony coverage with up to 20 degrees of tilt; pole-mounts up to two cabinets (pole-mount adapter not included).

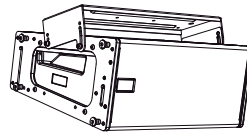

MDM-832 DISTRIBUTION MODULE

A complete LINA system can be conveniently powered using one MDM-832 unit per array, routing up to eight channels of AC power, balanced audio, and RMS to the loudspeakers.

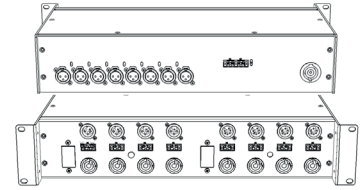

LINA SPECIFICATIONS⁴

ACOUSTICAL¹

Operating Frequency Range² 65 Hz – 18 kHz

TRANSDUCERS

Low Frequency Two 6.5-inch long-excursion cone drivers
High Frequency One 3-inch compression driver coupled to a constant-directivity horn through a patented REM[®] manifold

AUDIO I/O

Connectors³ XLR 3-pin or 5-pin female input with male loop output

AMPLIFIER

Type 3-channel, open-loop, class D

AC POWER

Connectors powerCON 20 input with loop output
Safety Rated Voltage Range 100–240 V AC, 50–60 Hz
Turn-on/off Points 90 V AC turn-on, no turn-off; internal fuse-protection above 265 V AC
Max. Long-Term Cont. Current 1.5 A rms (115 V AC); 0.8 A rms (230 V AC); 1.8 A rms (100 V AC)

RMS NETWORK (OPTIONAL)

Equipped with 2-conductor, twisted-pair network, reporting all amplifier operating parameters to host computer

PHYSICAL

Dimensions 20.27 inches W x 8.38 inches H x 15.32 inches D (515 mm x 213 mm x 389 mm)
Weight 43 lbs (19,5kg)
Enclosure Premium birch plywood
Finish Black textured
Protective Grille Powder-coated, hex-stamped steel with black mesh
Rigging End frames with four captive GuideALinks, secured with 0.25" x 0.53" quick-release pins; metric M6 attachment points for optional MYA-MINA mounting yoke and MUB-MINA U-bracket
Load Ratings MG-MINA multipurpose grid flies up to 16 LINA or MINA cabinets at 5:1 safety factor and BGV C 1. Some angle restrictions apply.

NOTES

- Loudspeaker system predictions for coverage and SPL available in Meyer Sound's MAPP software.
- Recommended maximum operating frequency range. Response depends on loading conditions and room acoustics.
- XLR 5-pin connectors accommodate both balanced audio and RMS signals.
- Preliminary Specifications – Subject to Change Without Notice

LINA —04.270.004.01 A

Copyright © 2017
Meyer Sound Laboratories Inc.
All rights reserved

MEYER SOUND LABORATORIES INC.
2832 San Pablo Avenue
Berkeley, CA 94702

+1 510 486.1166
techsupport@meyersound.com
www.meyersound.com